

Notes:  
 Do not scale from this drawing.  
 All contractors must visit the site and be responsible for taking and checking Dimensions.  
 All construction information should be taken from figured dimensions only.  
 Any discrepancies between drawings, specifications and site conditions must be brought to the attention of the supervising officer.  
 This drawing and the works depicted are the copyright of JTP.

This drawing is for planning purposes only. It is not intended to be used for construction purposes. Whilst all reasonable efforts are used to ensure drawings are accurate, JTP accept no responsibility or liability for any reliance placed on, or use made of, this plan by anyone for purposes other than those stated above.

- Red Line - Application boundary
- Blue Line - Other Land in the Applicant's control
- ⋯ Local Authority boundary
- Phase 0 including:
  - Riverside Park
  - Former Railway
  - Primary road corridor (with +/- 30m limit of deviation from centre line along route shown)
- Phase 1
- Phase 2
- Phase 3
- Existing sub-stations

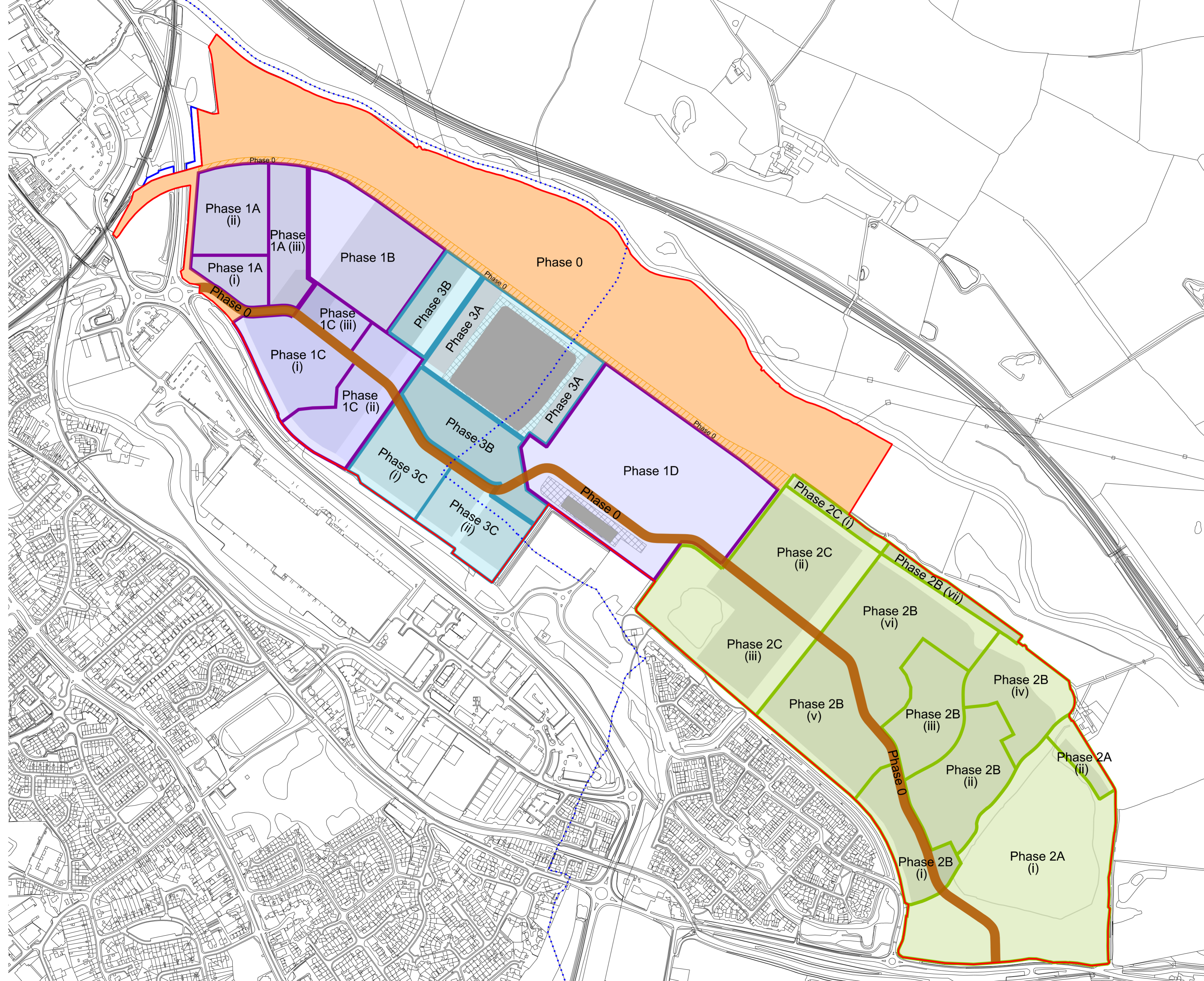

Note: The red line and associated area shown in this drawing are based on guidance provided by ENGIE. JTP accept no responsibility or liability for reliance placed on, or use made of, this plan by anyone for purposes other than planning.

Note: All features and areas are subject to a tolerance of +/- 10m unless stated otherwise

Rev	Date	Description	Drawn	Chkd
P5	06.03.20	ATS update	AM	GP
P4	01.10.19	blue line amended	VB	GP
P3	30.09.19	blue line amended	VB	GP
P2	24.09.19	red line amended	VB	GP
P1	18.09.19	First Issue	VB	GP

Drawing Status

**PLANNING**

Client

**ENGIE**



Project  
**Rugeley Power Station**

Drawing Title  
**Illustrative Phasing Plan**

Scale @ A2 1:5000 Job Ref. 01585  
 Drawing No. 01585\_PP\_06 Revision P5  
 Scale Bar 0 50 100 150m